

# ARCHIVE STORAGE

Tools required: Rubber mallet

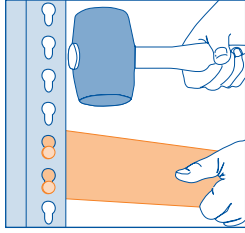

We advise the use of protective gloves and goggles, or eyeglasses when assembling this product.

The beam slots are tapered and fit into the slots as shown

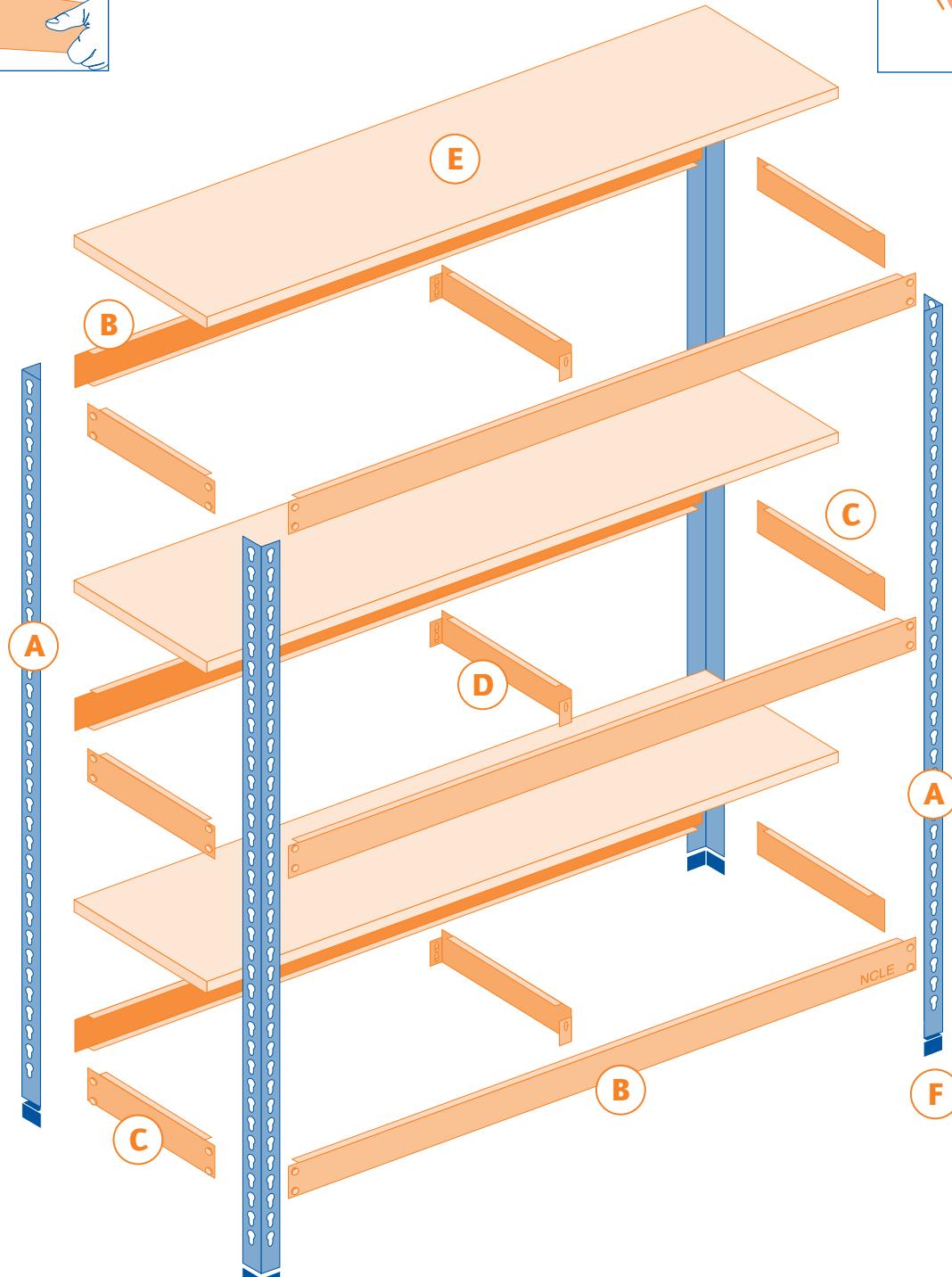
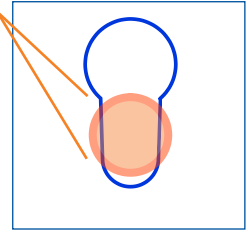

**IMPORTANT - ASSEMBLY INSTRUCTIONS**

## BAY ASSEMBLY

- 1 Fit plastic feet to uprights.
- 2 Assemble both ends first - **A** and **C**. Starting from the top allow 15 clear holes between each shelf support **C**.
- 3 Join both ends using front and rear beams **B**.
- 4 Add shelf supports **D**.
- 5 Add shelves **E**.

If you have any problems whatsoever please call **01452 223098** where a team of experts will be pleased to help.

**AIST001**

# ARCHIVE STORAGE

## COMPONENTS

### A Uprights

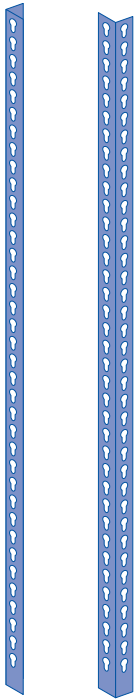

DS25/DD50 - 1448 mm  
DS35/DD70 - 2109 mm  
DS45/DD90 - 2743 mm

### B 1830mm front and rear beams



### C Side beams

DS units - 455 mm  
DD units - 915 mm



### E Shelves

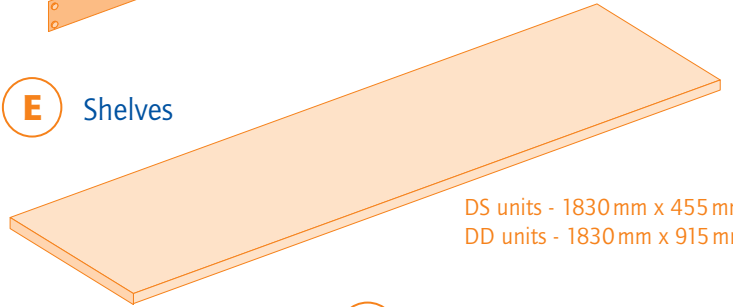

DS units - 1830 mm x 455 mm  
DD units - 1830 mm x 915 mm

### F Plastic feet

4 of



### D Shelf supports

DS units - 455 mm  
DD units - 915 mm

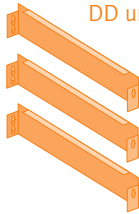

#### Rapid 1 Archive Storage, Component Check List

	DS25	DD50	DS35	DD70	DS45	DD90
Uprights 'A'	4	4	4	4	4	4
Front/Rear Beams 'B'	6	6	8	8	10	10
Side Beams 'C'	6	6	8	8	10	10
Shelf Supports 'D'	3	3	4	4	5	5
Chipboard Shelf 'E'	3	3	4	4	5	5
Plastic Foot 'F'	4	4	4	4	4	4
Archive Box 'G'	25	50	35	70	45	90

## BOX ASSEMBLY

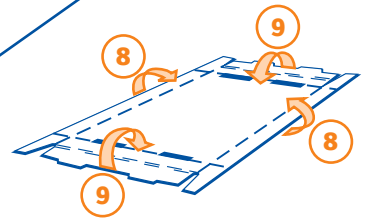
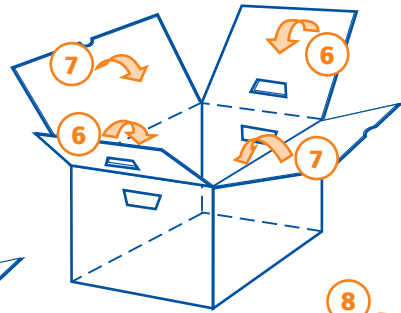
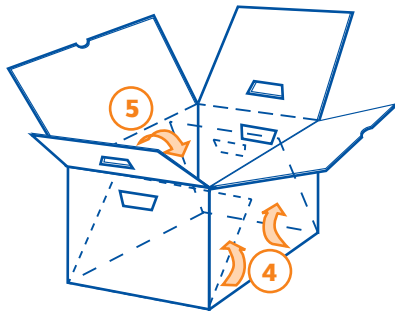
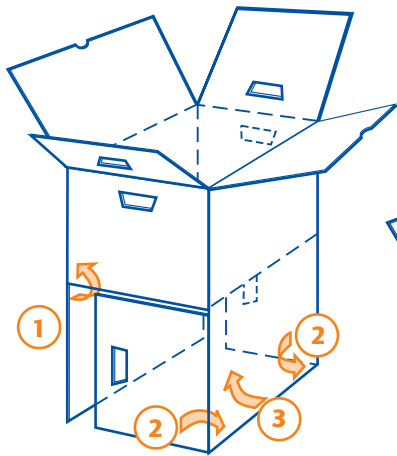

## SAFETY

					x4 2440 mm high  x6 4250 mm high
Keep heavier items on the bottom shelves		Keep your shelving dry	Do not climb on your shelving	Make sure it is on a level and even floor	Tie plates recommended with more than one bay