

# MEDIUM DUTY SHELVING

**IMPORTANT - ASSEMBLY INSTRUCTIONS**

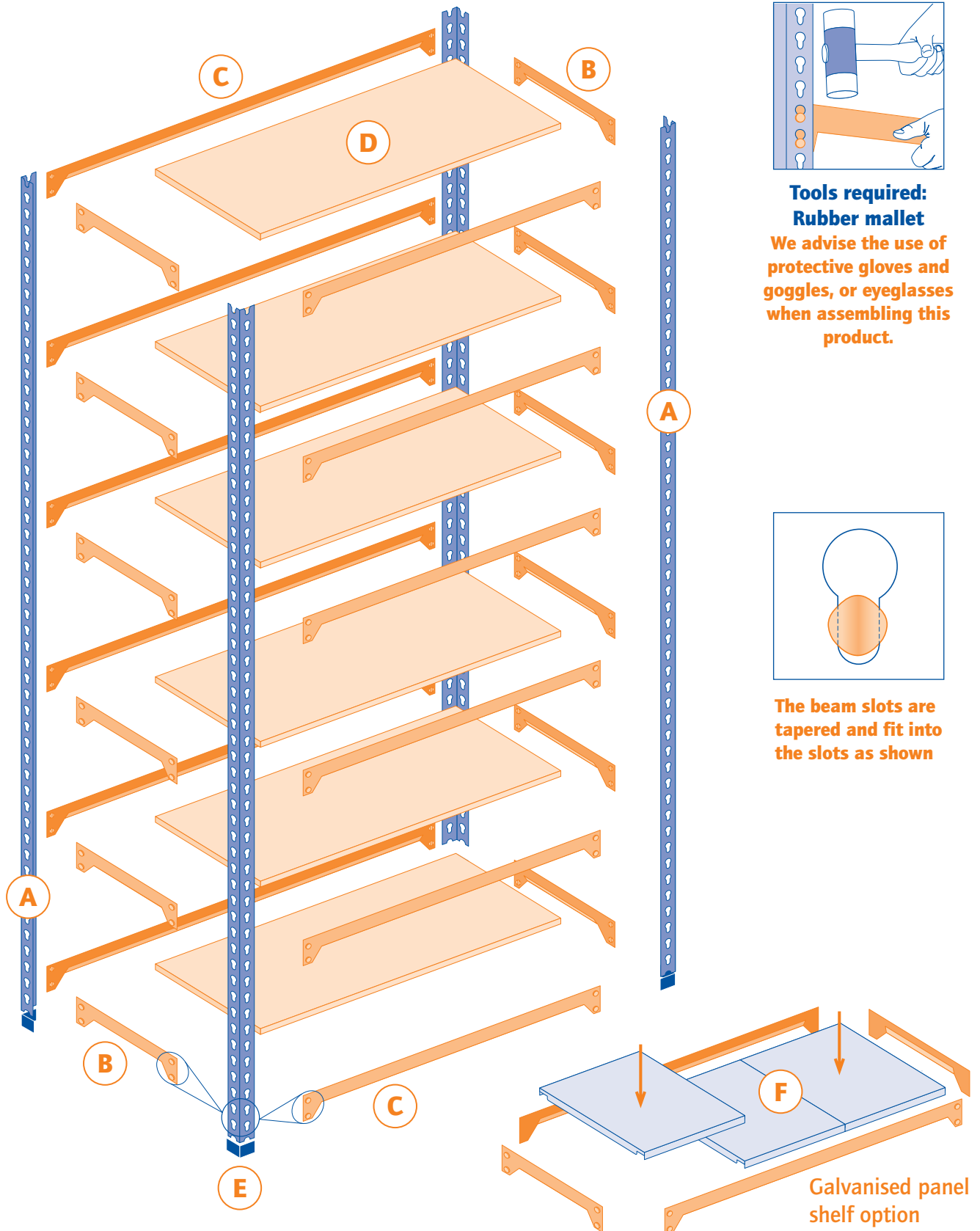

**Tools required:**  
**Rubber mallet**

We advise the use of protective gloves and goggles, or eyeglasses when assembling this product.

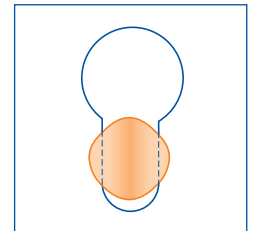

The beam slots are tapered and fit into the slots as shown

## ASSEMBLY - 6 shelf bay 1980mm high

- 1 Fit plastic feet **E** to uprights **A**.
- 2 Assemble both ends first - **A** and **B** starting from the bottom. For optimum clear entry allow 8 clear holes between each shelf support **B**.
- 3 Tap together using rubber mallet.
- 4 Join both ends using front and rear beams **C**.
- 5 Add shelves **D**.

If you have any problems with this product or its assembly, please contact your local distributor or call our helpline on **01452 223098** where a team of experts will be pleased to help.

**AI5003**

# MEDIUM DUTY SHELVING

## COMPONENTS

### A Uprights

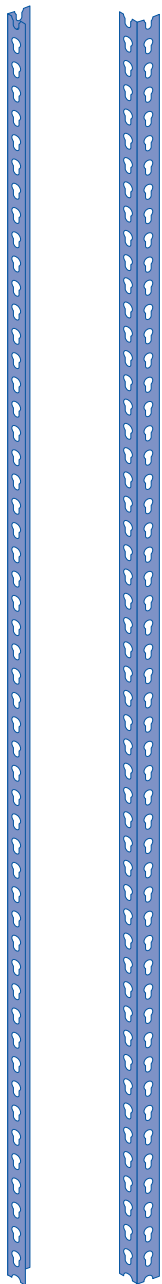

Available in: 990 mm, 1600 mm, 1980 mm, 2440 mm, 3050 mm and 3660 mm H

4 off

### B Side beams

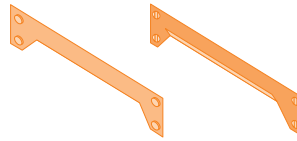

Either 305 mm, 380 mm, 455 mm, 610 mm, 760 mm or 915 mm  
2 off per shelf level

### C Front and rear beams

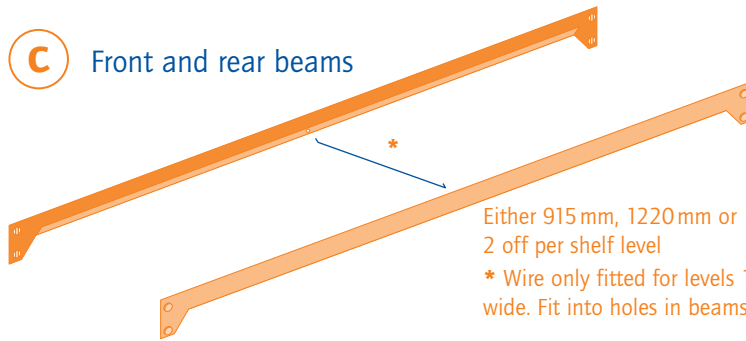

Either 915 mm, 1220 mm or 1525 mm  
2 off per shelf level

\* Wire only fitted for levels 1525mm wide. Fit into holes in beams.

### D Chipboard shelves

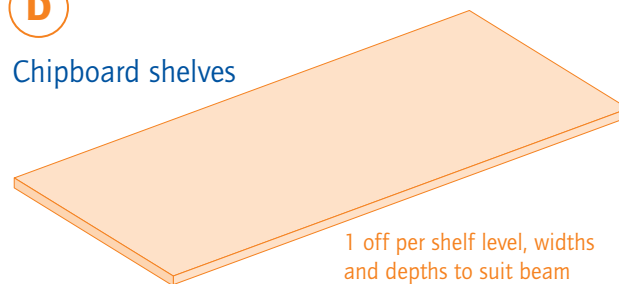

1 off per shelf level, widths and depths to suit beam

### E Plastic feet

4 off



### F Galvanised panels

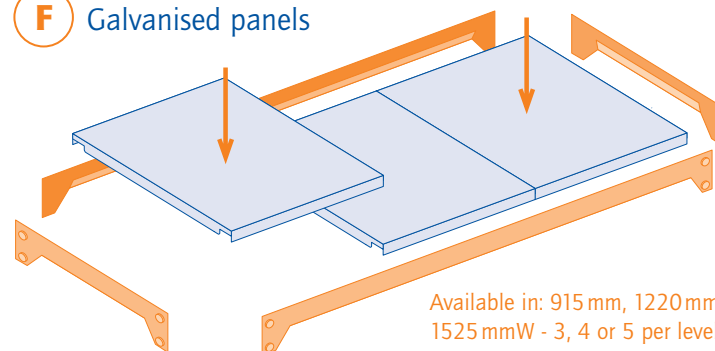

Available in: 915 mm, 1220 mm, 1525 mmW - 3, 4 or 5 per level

## SAFETY

					x4 up to 2440 mm high 
<b>Keep heavier items on the bottom shelves</b>		<b>Keep your shelving dry</b>	<b>Do not climb on your shelving</b>	<b>Make sure it is on a level and even floor</b>	x4 over 2440 mm high <b>Tie plates recommended with more than one bay</b>

If you have any problems with this product or its assembly, please contact your local distributor or call our helpline on **01452 223098** where a team of experts will be pleased to help.

AI5003

**IMPORTANT - ASSEMBLY INSTRUCTIONS**